

FiberGuide® System

RiserGuide



Because cable management requirements change with network requirements, ADC KRONE now offers the **RiserGuide System (RGS)**, designed to provide cable management where you need it, when you need it.

The RiserGuide System is flexible, modular and easy to install and remove, allowing for on-the-spot cable management and full network optimisation.

Features:

- Multiple standard width risers
- Various components can be installed anywhere on the riser
- Components include storage spools, radius limiters and cable guides
- Break-out cable slack storage

Benefits:

- RGS provides flexible, “on demand” cable management
- Cable management components can be installed anywhere on the riser
- Simple, tool-free installation
- Designed to meet GR-63 standard
- Supported by ADC KRONE’s cable management expertise

TECHNICAL DATA

FiberGuide® System

RiserGuide

Installation and Removal



Tool-less installation



Easy Removal



Specifications

Cable Guide Bracket

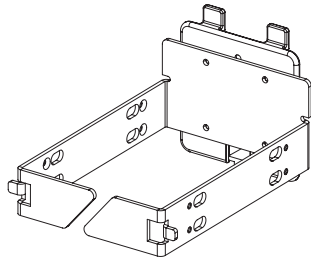

RGS-VC001-B

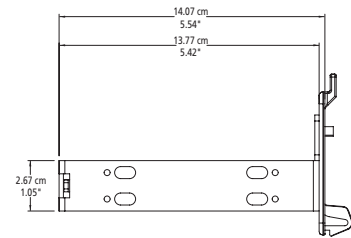
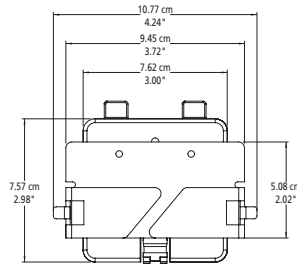

RiserGuide

06/06 • 101573BE

Edge Protectors

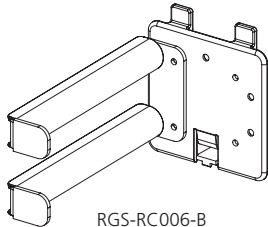

RGS-RC006-B

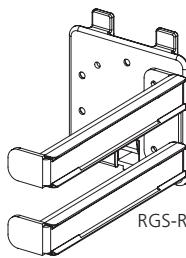

RGS-RC005-B

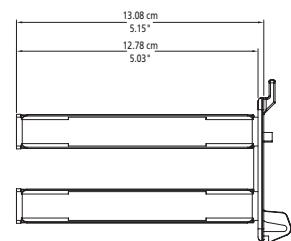
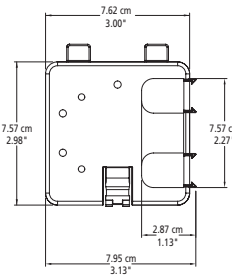

1.5 inch Bend Radius Spools

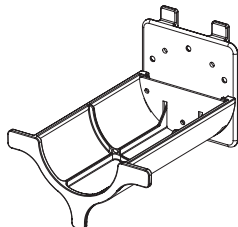

RGS-SC003-B

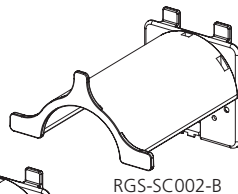

RGS-SC002-B

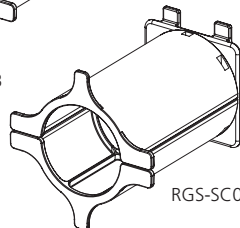

RGS-SC001-B

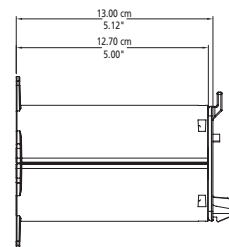
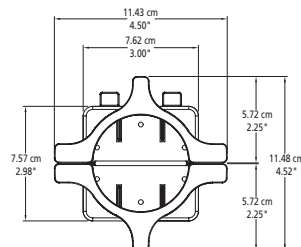

Radius Limiting Edge Protectors

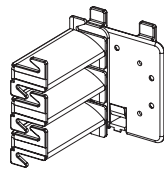

RGS-RC001-B

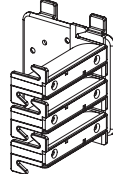

RGS-RC002-B

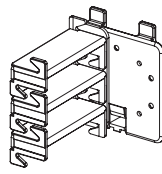

RGS-RC003-B

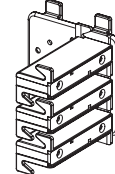

RGS-RC004-B

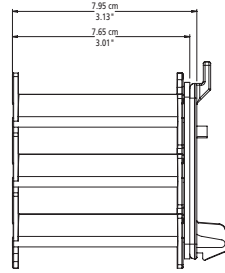
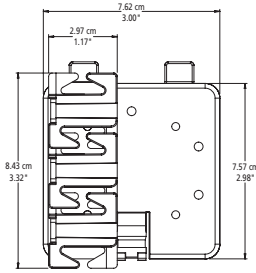

Vertical Risers

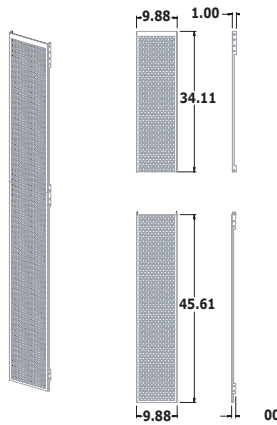

RGS-VOCX0A-P

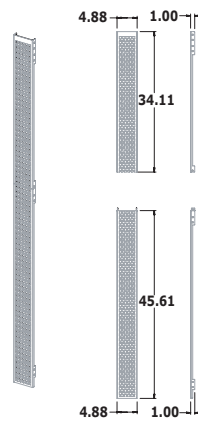

RGS-VOBX0A-P

06/06 • 101573BE RiserGuide

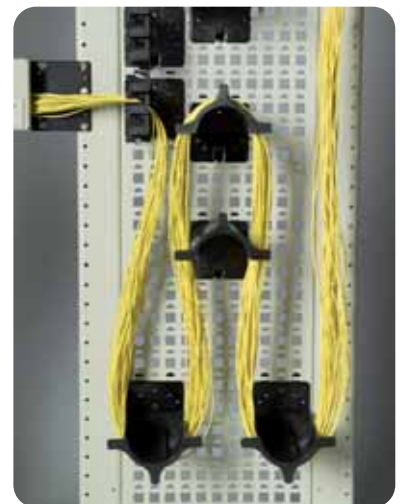

Ordering Information

Description	Catalogue Number
Cable Guide Bracket	RGS-VC001-B
Edge Protectors	
Edge Protector for Left-Hand Cable Entry/Exit	RGS-RC005-B
Edge Protector for Right-Hand Cable Entry/Exit	RGS-RC006-B
1.5" Bend Radius Spool	
Full Spool	RGS-SC001-B
Half Spool – Top	RGS-SC002-B
Half Spool – Bottom	RGS-SC003-B
Radius Limiting Edge Protector	
Fiber Exit – Right/Down	RGS-RC001-B
Fiber Exit – Left/Down	RGS-RC002-B
Fiber Exit – Right/Up	RGS-RC003-B
Fiber Exit – Left/Up	RGS-RC004-B
Vertical Risers	
7' x 10" Riser	RGS-V0CX0A-P
7' x 5" Riser	RGS-V0BX0A-P



Cable Guide Bracket



1.5" Radius Limiter



Edge Protector



1.5" Radius Limiting
Edge Protector



1.5" Bend Radius Spool

TECHNICAL DATA



Web Site: www.adckrone.com

EMEA Regional Office:

ADC GmbH, Beeskowdamm, 3-11, 14167 Berlin, Germany
Phone:+49 308 453 1818 • Fax: +49 30 8453-1703

For a listing of ADC KRONE's global sales office locations, please refer to our web site.

Specifications published here are current as of the date of publication of this document. Because we are continuously improving our products, ADC KRONE reserves the right to change specifications without prior notice. At any time, you may verify product specifications by contacting ADC Telecommunications, Inc. headquarters in Minneapolis. ADC Telecommunications, Inc. views its patent portfolio as an important corporate asset and vigorously enforces its patents.

Part Number 101573BE June 06 Revision © 2005, 2006 ADC Communications Ltd. All Rights Reserved